

Dimension: (UNIT:mm)

A	11.5 ± 0.3
B	7.8-0.4
C	5.2 _{-0.2}
D	3.6+0.2
E	9.4 ± 0.2
F	3.45-0.3
G	1.95-0.25
H	

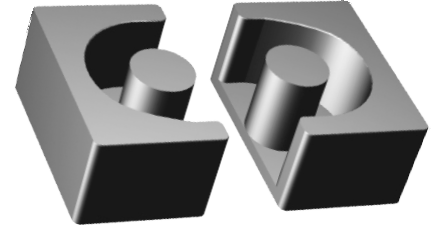
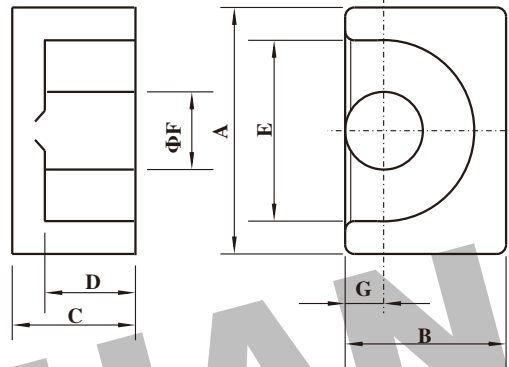

Test conditions

AL: F=1.0KHz U=0.3V N=10Ts

Effective parameter

C1(mm) ⁻¹	Ae(mm ²)	Le(mm)	Ve(mm ³)	Weight(g)
1.70	11.3	19.3	215	≈2.8

Core sets for filter applications.

Clamping force for AI measurements,30+/-10N.

Core sets of high permeability grades.

Clamping force for AI measurements,20+/-10N

Grade	AL (nH)	μe	Type number
H7K	3400±25%	≈4630	EP 10-H7K
H10K	4800+40/-30%	≈6530	EP 10-H10K
H12K	5400+40/-30%	≈7340	EP 10-H12K

Properties of core sets under power conditions

Grade	AL (nH)	μe	AIR GAP μm	Type number
P4	25 ± 3%	≈ 34	≈ 1010	EP 10-P4
	40 ± 3%	≈ 54	≈ 530	EP 10-P4
	63 ± 3%	≈ 86	≈ 290	EP 10-P4
	100 ± 3%	≈ 136	≈ 160	EP 10-P4
	160 ± 5%	≈ 217	≈ 90	EP 10-P4
	1140 ± 25%	≈ 1550	≈ 0	EP 10-P4
HQ2KA	1000 ± 25%	≈ 1350	≈ 0	EP 10-HQ2KA
HQ2K	25 ± 3%	≈ 34	≈ 1010	EP 10-HQ2K
	40 ± 3%	≈ 54	≈ 530	EP 10-HQ2K
	63 ± 3%	≈ 86	≈ 290	EP 10-HQ2K
	100 ± 3%	≈ 136	≈ 160	EP 10-HQ2K
	160 ± 5%	≈ 217	≈ 90	EP 10-HQ2K
	1000 ± 25%	≈ 1360	≈ 0	EP 10-HQ2K
P5	800 ± 25%	≈ 1090	≈ 0	EP 10-P5

Grade	B (mT)at	Core loss (w) at			
	H=250 A/m F=25KHz T=100℃	F=25 KHz B=200mT T=100℃	f=100 KHz B=100mT T=100℃	F=100 KHz B=200mT T=100℃	F=400 KHz B=50mT T=100℃
P4	≥320	-	≤0.019	≤0.1	-
HQ2KA	≥340	-	≤0.014	≤0.08	≤0.035
HQ2K	≥315	-	≤0.025	-	≤0.045
P5	≥300	-	-	-	≤0.02

Properties of core sets under power conditions (continued)

Grade	B (mT)at	Core loss (w) at			
	H=250 A/m F=25KHz T=100℃	F=500 KHz B=50mT T=100℃	F=500 KHz B=100mT T=100℃	F=1.0 MHz B=30mT T=100℃	F=3.0MHz B=10mT T=100℃
P4	≥320	-	-	-	-
HQ2KA	≥340	≤0.07	-	-	-
HQ2K	≥315	-	-	-	-
P5	≥300	≤0.025	≤0.2	-	-

Note:

- 1:Document is the property of FUAN Inc & is not allow to be duplicated without authorization
- 2:RoHS compliant.